

# Six Point Impact Sockets

**3/4"**  
**SQUARE**  
**DRIVE**

## Standard Fractional Sizes

| SIZE    | PART # | D1    | D2    | L     | T     | C     |
|---------|--------|-------|-------|-------|-------|-------|
| 1/2     | Z-1208 | 0.945 | 1.732 | 1.732 | 0.236 | 0.772 |
| 9/16    | Z-1209 | 0.984 | 1.732 | 1.732 | 0.276 | 0.772 |
| 5/8     | Z-1210 | 1.102 | 1.732 | 1.732 | 0.315 | 0.772 |
| 11/16   | Z-1211 | 1.142 | 1.732 | 1.732 | 0.354 | 0.772 |
| 3/4     | Z-1212 | 1.260 | 1.732 | 1.732 | 0.372 | 0.772 |
| 13/16   | Z-1213 | 1.378 | 1.732 | 1.890 | 0.433 | 0.890 |
| 7/8     | Z-1214 | 1.496 | 1.732 | 1.890 | 0.512 | 0.890 |
| 15/16   | Z-1215 | 1.575 | 1.732 | 1.890 | 0.512 | 0.890 |
| 1       | Z-1216 | 1.614 | 1.732 | 1.890 | 0.512 | 0.890 |
| 1-1/16  | Z-1217 | 1.732 | 1.732 | 2.047 | 0.512 | 1.047 |
| 1-1/8   | Z-1218 | 1.732 | 1.732 | 2.047 | 0.650 | 1.047 |
| 1-3/16  | Z-1219 | 1.732 | 1.732 | 2.047 | 0.650 | 1.047 |
| 1-1/4   | Z-1220 | 1.929 | 1.732 | 2.047 | 0.650 | 1.047 |
| 1-5/16  | Z-1221 | 1.929 | 1.732 | 2.165 | 0.748 | 1.165 |
| 1-3/8   | Z-1222 | 2.047 | 1.732 | 2.165 | 0.748 | 1.165 |
| 1-7/16  | Z-1223 | 2.047 | 1.732 | 2.205 | 0.748 | 1.205 |
| 1-1/2   | Z-1224 | 2.126 | 1.732 | 2.283 | 0.866 | 1.283 |
| 1-9/16  | Z-1225 | 2.244 | 1.732 | 2.283 | 0.866 | 1.283 |
| 1-5/8   | Z-1226 | 2.244 | 1.732 | 2.283 | 0.866 | 1.283 |
| 1-11/16 | Z-1227 | 2.480 | 1.732 | 2.441 | 0.984 | 1.441 |
| 1-3/4   | Z-1228 | 2.480 | 1.732 | 2.480 | 0.995 | 1.480 |
| 1-13/16 | Z-1229 | 2.638 | 1.732 | 2.480 | 0.995 | 1.480 |
| 1-7/8   | Z-1230 | 2.638 | 2.126 | 2.598 | 1.062 | 1.598 |
| 1-15/16 | Z-1231 | 2.756 | 2.126 | 2.598 | 1.062 | 1.598 |
| 2       | Z-1232 | 2.874 | 2.126 | 2.598 | 1.062 | 1.598 |
| 2-1/16  | Z-1233 | 2.874 | 2.126 | 2.756 | 1.181 | 1.756 |
| 2-1/8   | Z-1234 | 2.874 | 2.126 | 2.795 | 1.181 | 1.795 |
| 2-3/16  | Z-1235 | 3.071 | 2.126 | 2.795 | 1.260 | 1.795 |
| 2-1/4   | Z-1236 | 3.228 | 2.126 | 2.913 | 1.299 | 1.913 |
| 2-5/16  | Z-1237 | 3.228 | 2.126 | 2.953 | 1.299 | 1.953 |
| 2-3/8   | Z-1238 | 3.228 | 2.126 | 2.953 | 1.378 | 1.953 |

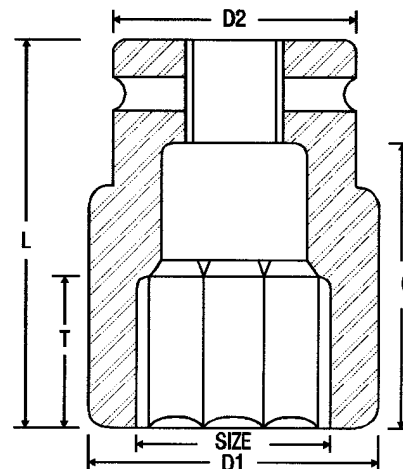

## Deep Fractional Sizes

| SIZE    | PART #  | D1    | D2    | L     | T     | C     |
|---------|---------|-------|-------|-------|-------|-------|
| 1/2     | Z-1208L | 0.945 | 1.732 | 3.543 | 0.236 | 2.543 |
| 9/16    | Z-1209L | 0.984 | 1.732 | 3.543 | 0.276 | 2.543 |
| 5/8     | Z-1210L | 1.102 | 1.732 | 3.543 | 0.315 | 2.543 |
| 11/16   | Z-1211L | 1.142 | 1.732 | 3.543 | 0.354 | 2.543 |
| 3/4     | Z-1212L | 1.260 | 1.732 | 3.543 | 0.372 | 2.543 |
| 13/16   | Z-1213L | 1.378 | 1.732 | 3.543 | 0.433 | 2.543 |
| 7/8     | Z-1214L | 1.496 | 1.732 | 3.543 | 0.512 | 2.543 |
| 15/16   | Z-1215L | 1.575 | 1.732 | 3.543 | 0.512 | 2.543 |
| 1       | Z-1216L | 1.614 | 1.732 | 3.543 | 0.512 | 2.543 |
| 1-1/16  | Z-1217L | 1.732 | 1.732 | 3.543 | 0.512 | 2.543 |
| 1-1/8   | Z-1218L | 1.732 | 1.732 | 3.543 | 0.650 | 2.543 |
| 1-3/16  | Z-1219L | 1.732 | 1.732 | 3.543 | 0.650 | 2.543 |
| 1-1/4   | Z-1220L | 1.929 | 1.732 | 3.543 | 0.669 | 2.543 |
| 1-5/16  | Z-1221L | 1.929 | 1.732 | 3.543 | 0.748 | 2.543 |
| 1-3/8   | Z-1222L | 2.047 | 1.732 | 3.543 | 0.748 | 2.543 |
| 1-7/16  | Z-1223L | 2.047 | 1.732 | 3.543 | 0.748 | 2.543 |
| 1-1/2   | Z-1224L | 2.126 | 1.732 | 3.543 | 0.866 | 2.543 |
| 1-9/16  | Z-1225L | 2.244 | 1.732 | 3.543 | 0.866 | 2.543 |
| 1-5/8   | Z-1226L | 2.244 | 1.732 | 3.543 | 0.866 | 2.543 |
| 1-11/16 | Z-1227L | 2.480 | 1.732 | 3.543 | 0.984 | 2.543 |
| 1-3/4   | Z-1228L | 2.480 | 1.732 | 3.543 | 0.995 | 2.543 |
| 1-13/16 | Z-1229L | 2.638 | 1.732 | 3.543 | 0.995 | 2.543 |
| 1-7/8   | Z-1230L | 2.638 | 2.126 | 3.543 | 1.062 | 2.543 |
| 1-15/16 | Z-1231L | 2.756 | 2.126 | 3.543 | 1.062 | 2.543 |
| 2       | Z-1232L | 2.874 | 2.126 | 3.543 | 1.062 | 2.543 |
| 2-1/16  | Z-1233L | 2.874 | 2.126 | 3.701 | 1.181 | 2.701 |
| 2-1/8   | Z-1234L | 2.874 | 2.126 | 3.740 | 1.181 | 2.740 |
| 2-3/16  | Z-1235L | 3.071 | 2.126 | 3.740 | 1.260 | 2.740 |
| 2-1/4   | Z-1236L | 3.228 | 2.126 | 3.858 | 1.299 | 2.858 |
| 2-5/16  | Z-1237L | 3.228 | 2.126 | 3.898 | 1.299 | 2.898 |
| 2-3/8   | Z-1238L | 3.228 | 2.126 | 3.898 | 1.378 | 2.898 |

**3/4"**  
**SQUARE**  
**DRIVE**

# Six Point Impact Sockets

## Standard Metric Sizes

| SIZE | PART #  | D1 | D2 | L  | T    | C  |
|------|---------|----|----|----|------|----|
| 13   | Z-12M13 | 25 | 44 | 45 | 6    | 20 |
| 14   | Z-12M14 | 25 | 44 | 45 | 7    | 20 |
| 15   | Z-12M15 | 28 | 44 | 45 | 7    | 20 |
| 16   | Z-12M16 | 29 | 44 | 45 | 7    | 20 |
| 17   | Z-12M17 | 29 | 44 | 45 | 9    | 20 |
| 18   | Z-12M18 | 32 | 44 | 45 | 9    | 20 |
| 19   | Z-12M19 | 32 | 44 | 45 | 9.5  | 20 |
| 20   | Z-12M20 | 35 | 44 | 46 | 10   | 21 |
| 21   | Z-12M21 | 35 | 44 | 46 | 10   | 21 |
| 22   | Z-12M22 | 38 | 44 | 46 | 10   | 21 |
| 23   | Z-12M23 | 38 | 44 | 46 | 12   | 21 |
| 24   | Z-12M24 | 40 | 44 | 46 | 12   | 21 |
| 25   | Z-12M25 | 41 | 44 | 46 | 13   | 21 |
| 26   | Z-12M26 | 41 | 44 | 46 | 13   | 21 |
| 27   | Z-12M27 | 41 | 44 | 48 | 13   | 23 |
| 28   | Z-12M28 | 44 | 44 | 48 | 14   | 23 |
| 29   | Z-12M29 | 44 | 44 | 52 | 14   | 27 |
| 30   | Z-12M30 | 44 | 44 | 52 | 16.5 | 27 |
| 31   | Z-12M31 | 49 | 44 | 52 | 16.5 | 27 |
| 32   | Z-12M32 | 49 | 44 | 52 | 16.5 | 27 |
| 33   | Z-12M33 | 49 | 44 | 55 | 17   | 30 |
| 34   | Z-12M34 | 52 | 44 | 55 | 17   | 30 |
| 35   | Z-12M35 | 52 | 44 | 55 | 19   | 30 |
| 36   | Z-12M36 | 52 | 44 | 56 | 19   | 31 |
| 37   | Z-12M37 | 54 | 44 | 56 | 19   | 31 |
| 38   | Z-12M38 | 54 | 44 | 59 | 22   | 34 |
| 39   | Z-12M39 | 57 | 44 | 59 | 21.5 | 34 |
| 40   | Z-12M40 | 57 | 44 | 59 | 21.5 | 34 |
| 41   | Z-12M41 | 57 | 44 | 59 | 22   | 34 |
| 42   | Z-12M42 | 60 | 44 | 59 | 21.5 | 34 |
| 43   | Z-12M43 | 63 | 44 | 64 | 25   | 39 |
| 44   | Z-12M44 | 63 | 44 | 64 | 21.5 | 39 |
| 45   | Z-12M45 | 63 | 44 | 64 | 21.5 | 39 |
| 46   | Z-12M46 | 67 | 44 | 64 | 25.5 | 39 |
| 47   | Z-12M47 | 67 | 54 | 64 | 23.5 | 39 |
| 48   | Z-12M48 | 67 | 54 | 67 | 23.5 | 42 |
| 49   | Z-12M49 | 70 | 54 | 67 | 27   | 42 |
| 50   | Z-12M50 | 70 | 54 | 67 | 23.5 | 42 |
| 51   | Z-12M51 | 73 | 54 | 67 | 27   | 42 |
| 52   | Z-12M52 | 73 | 54 | 70 | 27   | 45 |
| 54   | Z-12M54 | 78 | 54 | 71 | 30   | 46 |
| 55   | Z-12M55 | 78 | 54 | 71 | 27   | 46 |
| 56   | Z-12M56 | 78 | 54 | 74 | 28   | 49 |
| 57   | Z-12M57 | 82 | 54 | 75 | 33   | 50 |
| 58   | Z-12M58 | 82 | 54 | 75 | 28   | 50 |
| 59   | Z-12M59 | 82 | 54 | 75 | 33   | 50 |
| 60   | Z-12M60 | 82 | 54 | 75 | 28   | 50 |
| 61   | Z-12M61 | 86 | 54 | 75 | 28   | 50 |

## Deep Metric Sizes

| SIZE | PART #   | D1 | D2 | L  | T    | C  |
|------|----------|----|----|----|------|----|
| 13   | Z-12M13L | 25 | 44 | 90 | 6    | 65 |
| 14   | Z-12M14L | 25 | 44 | 90 | 7    | 65 |
| 15   | Z-12M15L | 28 | 44 | 90 | 7    | 65 |
| 16   | Z-12M16L | 29 | 44 | 90 | 7    | 65 |
| 17   | Z-12M17L | 29 | 44 | 90 | 9    | 65 |
| 18   | Z-12M18L | 32 | 44 | 90 | 9    | 65 |
| 19   | Z-12M19L | 32 | 44 | 90 | 9.5  | 65 |
| 20   | Z-12M20L | 35 | 44 | 90 | 10   | 65 |
| 21   | Z-12M21L | 35 | 44 | 90 | 10   | 65 |
| 22   | Z-12M22L | 38 | 44 | 90 | 10   | 65 |
| 23   | Z-12M23L | 38 | 44 | 90 | 12   | 65 |
| 24   | Z-12M24L | 40 | 44 | 90 | 12   | 65 |
| 25   | Z-12M25L | 41 | 44 | 90 | 13   | 65 |
| 26   | Z-12M26L | 41 | 44 | 90 | 13   | 65 |
| 27   | Z-12M27L | 41 | 44 | 90 | 13   | 65 |
| 28   | Z-12M28L | 44 | 44 | 90 | 14   | 65 |
| 29   | Z-12M29L | 44 | 44 | 90 | 14   | 65 |
| 30   | Z-12M30L | 44 | 44 | 90 | 16.5 | 65 |
| 31   | Z-12M31L | 49 | 44 | 90 | 16.5 | 65 |
| 32   | Z-12M32L | 49 | 44 | 90 | 16.5 | 65 |
| 33   | Z-12M33L | 49 | 44 | 90 | 17   | 65 |
| 34   | Z-12M34L | 52 | 44 | 90 | 17   | 65 |
| 35   | Z-12M35L | 52 | 44 | 90 | 19   | 65 |
| 36   | Z-12M36L | 52 | 44 | 90 | 19   | 65 |
| 37   | Z-12M37L | 54 | 44 | 90 | 19   | 65 |
| 38   | Z-12M38L | 54 | 44 | 90 | 22   | 65 |
| 39   | Z-12M39L | 57 | 44 | 90 | 21.5 | 65 |
| 40   | Z-12M40L | 57 | 44 | 90 | 21.5 | 65 |
| 41   | Z-12M41L | 57 | 44 | 90 | 22   | 65 |
| 42   | Z-12M42L | 60 | 44 | 90 | 21.5 | 65 |
| 43   | Z-12M43L | 63 | 44 | 90 | 25   | 65 |
| 44   | Z-12M44L | 63 | 44 | 90 | 21.5 | 65 |
| 45   | Z-12M45L | 63 | 44 | 90 | 21.5 | 65 |
| 46   | Z-12M46L | 67 | 44 | 90 | 25.5 | 65 |
| 47   | Z-12M47L | 67 | 54 | 90 | 23.5 | 65 |
| 48   | Z-12M48L | 67 | 54 | 90 | 23.5 | 65 |
| 49   | Z-12M49L | 70 | 54 | 90 | 27   | 65 |
| 50   | Z-12M50L | 70 | 54 | 90 | 23.5 | 65 |
| 51   | Z-12M51L | 73 | 54 | 90 | 27   | 65 |
| 52   | Z-12M52L | 73 | 54 | 94 | 27   | 69 |
| 54   | Z-12M54L | 78 | 54 | 94 | 30   | 69 |
| 55   | Z-12M55L | 78 | 54 | 94 | 27   | 69 |
| 56   | Z-12M56L | 78 | 54 | 98 | 28   | 73 |
| 57   | Z-12M57L | 82 | 54 | 98 | 33   | 73 |
| 58   | Z-12M58L | 82 | 54 | 98 | 28   | 73 |
| 59   | Z-12M59L | 82 | 54 | 98 | 33   | 73 |
| 60   | Z-12M60L | 82 | 54 | 98 | 28   | 73 |
| 61   | Z-12M61L | 86 | 54 | 98 | 28   | 73 |

## BUDD Wheel Sockets

| SIZE           | PART #   | D1    | D2    | L     | T     |
|----------------|----------|-------|-------|-------|-------|
| 13/16          | Z-1213B  | 1.653 | 1.732 | 1.968 | 0.433 |
| 13/16          | Z-1213BL | 1.653 | 1.732 | 3.543 | 0.433 |
| 13/16 X 1 1/12 | Z-1224BS | 2.126 | 1.732 | 3.543 | 0.571 |

# Six Point Impact Sockets

**3/4"**  
**SQUARE**  
**DRIVE**

## Standard Fractional Thinwall

| SIZE    | PART #  | D1    | D2    | L     | T     | C     |
|---------|---------|-------|-------|-------|-------|-------|
| 11/16   | Z-1211T | 1.102 | 1.732 | 1.969 | 0.354 | 0.969 |
| 3/4     | Z-1212T | 1.181 | 1.732 | 1.969 | 0.375 | 0.969 |
| 13/16   | Z-1213T | 1.378 | 1.732 | 1.969 | 0.433 | 0.969 |
| 7/8     | Z-1214T | 1.378 | 1.732 | 1.969 | 0.512 | 0.969 |
| 15/16   | Z-1215T | 1.378 | 1.732 | 1.969 | 0.512 | 0.969 |
| 1       | Z-1216T | 1.496 | 1.732 | 1.969 | 0.512 | 0.969 |
| 1-1/16  | Z-1217T | 1.614 | 1.732 | 2.047 | 0.512 | 1.047 |
| 1-1/8   | Z-1218T | 1.614 | 1.732 | 2.047 | 0.650 | 1.047 |
| 1-3/16  | Z-1219T | 1.732 | 1.732 | 2.047 | 0.650 | 1.047 |
| 1-1/4   | Z-1220T | 1.732 | 1.732 | 2.047 | 0.669 | 1.047 |
| 1-5/16  | Z-1221T | 1.929 | 1.732 | 2.165 | 0.748 | 1.165 |
| 1-3/8   | Z-1222T | 2.047 | 1.732 | 2.165 | 0.748 | 1.165 |
| 1-7/16  | Z-1223T | 2.047 | 1.732 | 2.205 | 0.748 | 1.205 |
| 1-1/2   | Z-1224T | 2.126 | 1.732 | 2.283 | 0.866 | 1.283 |
| 1-9/16  | Z-1225T | 2.126 | 1.732 | 2.283 | 0.866 | 1.283 |
| 1-5/8   | Z-1226T | 2.126 | 1.732 | 2.283 | 0.866 | 1.283 |
| 1-11/16 | Z-1227T | 2.362 | 1.732 | 2.441 | 0.984 | 1.441 |
| 1-3/4   | Z-1228T | 2.362 | 1.732 | 2.480 | 0.995 | 1.480 |
| 1-13/16 | Z-1229T | 2.480 | 1.732 | 2.480 | 0.995 | 1.480 |

## Deep Fractional Thinwall

| SIZE    | PART #   | D1    | D2    | L     | T     | C     |
|---------|----------|-------|-------|-------|-------|-------|
| 11/16   | Z-1211LT | 1.102 | 1.732 | 3.543 | 0.709 | 2.543 |
| 3/4     | Z-1212LT | 1.181 | 1.732 | 3.543 | 0.748 | 2.543 |
| 13/16   | Z-1213LT | 1.378 | 1.732 | 3.543 | 0.866 | 2.543 |
| 7/8     | Z-1214LT | 1.378 | 1.732 | 3.543 | 1.024 | 2.543 |
| 15/16   | Z-1215LT | 1.378 | 1.732 | 3.543 | 1.024 | 2.543 |
| 1       | Z-1216LT | 1.496 | 1.732 | 3.543 | 1.024 | 2.543 |
| 1-1/16  | Z-1217LT | 1.614 | 1.732 | 3.543 | 1.024 | 2.543 |
| 1-1/8   | Z-1218LT | 1.614 | 1.732 | 3.543 | 1.299 | 2.543 |
| 1-3/16  | Z-1219LT | 1.732 | 1.732 | 3.543 | 1.299 | 2.543 |
| 1-1/4   | Z-1220LT | 1.732 | 1.732 | 3.543 | 1.339 | 2.543 |
| 1-5/16  | Z-1221LT | 1.929 | 1.732 | 3.543 | 1.496 | 2.543 |
| 1-3/8   | Z-1222LT | 2.047 | 1.732 | 3.543 | 1.496 | 2.543 |
| 1-7/16  | Z-1223LT | 2.047 | 1.732 | 3.543 | 1.496 | 2.543 |
| 1-1/2   | Z-1224LT | 2.126 | 1.732 | 3.543 | 1.732 | 2.543 |
| 1-9/16  | Z-1225LT | 2.126 | 1.732 | 3.543 | 1.732 | 2.543 |
| 1-5/8   | Z-1226LT | 2.126 | 1.732 | 3.543 | 1.732 | 2.543 |
| 1-11/16 | Z-1227LT | 2.362 | 1.732 | 3.543 | 1.969 | 2.543 |
| 1-3/4   | Z-1228LT | 2.362 | 1.732 | 3.543 | 2.008 | 2.543 |
| 1-13/16 | Z-1229LT | 2.480 | 1.732 | 3.543 | 2.008 | 2.543 |

## Standard Metric Thinwall

| SIZE | PART #   | D1 | D2 | L  | T    | C  |
|------|----------|----|----|----|------|----|
| 17   | Z-12M17T | 28 | 44 | 45 | 9    | 20 |
| 18   | Z-12M18T | 30 | 44 | 45 | 9    | 20 |
| 19   | Z-12M19T | 30 | 44 | 46 | 9.5  | 21 |
| 20   | Z-12M20T | 30 | 44 | 46 | 10   | 21 |
| 21   | Z-12M21T | 35 | 44 | 46 | 10   | 21 |
| 22   | Z-12M22T | 35 | 44 | 46 | 10   | 21 |
| 23   | Z-12M23T | 35 | 44 | 46 | 12   | 21 |
| 24   | Z-12M24T | 38 | 44 | 46 | 12   | 21 |
| 25   | Z-12M25T | 38 | 44 | 46 | 13   | 21 |
| 26   | Z-12M26T | 41 | 44 | 46 | 13   | 21 |
| 27   | Z-12M27T | 41 | 44 | 48 | 13   | 23 |
| 28   | Z-12M28T | 41 | 44 | 48 | 14   | 23 |
| 29   | Z-12M29T | 41 | 44 | 52 | 14   | 27 |
| 30   | Z-12M30T | 41 | 44 | 52 | 16.5 | 27 |
| 31   | Z-12M31T | 44 | 44 | 52 | 16.5 | 27 |
| 32   | Z-12M32T | 48 | 44 | 52 | 16.5 | 27 |
| 33   | Z-12M33T | 48 | 44 | 55 | 17   | 30 |
| 34   | Z-12M34T | 49 | 44 | 55 | 17   | 30 |
| 35   | Z-12M35T | 50 | 44 | 55 | 19   | 30 |
| 36   | Z-12M36T | 52 | 44 | 56 | 19   | 31 |
| 37   | Z-12M37T | 52 | 44 | 56 | 19   | 31 |
| 38   | Z-12M38T | 52 | 44 | 59 | 22   | 34 |
| 39   | Z-12M39T | 54 | 44 | 59 | 21.5 | 34 |
| 40   | Z-12M40T | 54 | 44 | 59 | 21.5 | 34 |
| 41   | Z-12M41T | 54 | 44 | 59 | 22   | 34 |
| 42   | Z-12M42T | 57 | 44 | 59 | 21.5 | 34 |
| 43   | Z-12M43T | 60 | 44 | 64 | 25   | 39 |
| 44   | Z-12M44T | 60 | 44 | 64 | 21.5 | 39 |
| 45   | Z-12M45T | 60 | 44 | 64 | 21.5 | 39 |
| 46   | Z-12M46T | 63 | 44 | 64 | 25.5 | 39 |

## Deep Metric Thinwall

| SIZE | PART #    | D1 | D2 | L  | T  | C  |
|------|-----------|----|----|----|----|----|
| 17   | Z-12M17LT | 28 | 44 | 90 | 18 | 65 |
| 18   | Z-12M18LT | 30 | 44 | 90 | 18 | 65 |
| 19   | Z-12M19LT | 30 | 44 | 90 | 19 | 65 |
| 20   | Z-12M20LT | 30 | 44 | 90 | 20 | 65 |
| 21   | Z-12M21LT | 35 | 44 | 90 | 20 | 65 |
| 22   | Z-12M22LT | 35 | 44 | 90 | 20 | 65 |
| 23   | Z-12M23LT | 35 | 44 | 90 | 24 | 65 |
| 24   | Z-12M24LT | 38 | 44 | 90 | 24 | 65 |
| 25   | Z-12M25LT | 38 | 44 | 90 | 26 | 65 |
| 26   | Z-12M26LT | 41 | 44 | 90 | 26 | 65 |
| 27   | Z-12M27LT | 41 | 44 | 90 | 26 | 65 |
| 28   | Z-12M28LT | 41 | 44 | 90 | 28 | 65 |
| 29   | Z-12M29LT | 41 | 44 | 90 | 28 | 65 |
| 30   | Z-12M30LT | 41 | 44 | 90 | 33 | 65 |
| 31   | Z-12M31LT | 44 | 44 | 90 | 33 | 65 |
| 32   | Z-12M32LT | 48 | 44 | 90 | 33 | 65 |
| 33   | Z-12M33LT | 48 | 44 | 90 | 34 | 65 |
| 34   | Z-12M34LT | 49 | 44 | 90 | 34 | 65 |
| 35   | Z-12M35LT | 50 | 44 | 90 | 38 | 65 |
| 36   | Z-12M36LT | 52 | 44 | 90 | 38 | 65 |
| 37   | Z-12M37LT | 52 | 44 | 90 | 38 | 65 |
| 38   | Z-12M38LT | 52 | 44 | 90 | 44 | 65 |
| 39   | Z-12M39LT | 54 | 44 | 90 | 43 | 65 |
| 40   | Z-12M40LT | 54 | 44 | 90 | 43 | 65 |
| 41   | Z-12M41LT | 54 | 44 | 90 | 44 | 65 |
| 42   | Z-12M42LT | 57 | 44 | 90 | 43 | 65 |
| 43   | Z-12M43LT | 60 | 44 | 90 | 50 | 65 |
| 44   | Z-12M44LT | 60 | 44 | 90 | 43 | 65 |
| 45   | Z-12M45LT | 60 | 44 | 90 | 43 | 65 |
| 46   | Z-12M46LT | 63 | 44 | 90 | 51 | 65 |

# 3/4" SQUARE DRIVE

# Hex Driver Sockets

## Fractional Sizes

| SIZE  | PART #  | D1    | L     | T     |
|-------|---------|-------|-------|-------|
| 3/8   | Z-1206H | 1.496 | 2.637 | 1.130 |
| 7/16  | Z-1207H | 1.496 | 2.637 | 1.130 |
| 1/2   | Z-1208H | 1.496 | 2.637 | 1.130 |
| 9/16  | Z-1209H | 1.496 | 2.637 | 1.130 |
| 5/8   | Z-1210H | 1.496 | 2.637 | 1.130 |
| 3/4   | Z-1212H | 1.732 | 2.637 | 1.130 |
| 13/16 | Z-1213H | 1.732 | 2.795 | 1.295 |
| 7/8   | Z-1214H | 1.732 | 2.795 | 1.295 |
| 1     | Z-1216H | 1.732 | 2.795 | 1.295 |



## Metric Sizes

| SIZE | PART #   | D1 | L  | T  |
|------|----------|----|----|----|
| 10   | Z-12M10H | 38 | 67 | 29 |
| 12   | Z-12M12H | 38 | 67 | 29 |
| 14   | Z-12M14H | 38 | 67 | 29 |
| 17   | Z-12M17H | 38 | 67 | 29 |
| 19   | Z-12M19H | 44 | 67 | 29 |
| 22   | Z-12M22H | 44 | 71 | 33 |
| 24   | Z-12M24H | 44 | 71 | 33 |

# Double Square Impact Sockets



## Standard Fractional

| SIZE    | PART #  | D1    | D2    | L     | T     | C     |
|---------|---------|-------|-------|-------|-------|-------|
| 1-1/4   | DS-1220 | 2.362 | 1.732 | 2.087 | 0.669 | 1.087 |
| 1-5/16  | DS-1221 | 2.480 | 1.732 | 2.087 | 0.748 | 1.087 |
| 1-3/8   | DS-1222 | 2.638 | 1.732 | 2.087 | 0.748 | 1.087 |
| 1-7/16  | DS-1223 | 2.638 | 1.732 | 2.244 | 0.748 | 1.244 |
| 1-1/2   | DS-1224 | 2.638 | 1.732 | 2.244 | 0.866 | 1.244 |
| 1-9/16  | DS-1225 | 3.071 | 2.126 | 2.244 | 0.866 | 1.244 |
| 1-5/8   | DS-1226 | 3.071 | 2.126 | 2.244 | 0.866 | 1.244 |
| 1-11/16 | DS-1227 | 3.228 | 2.126 | 2.441 | 0.984 | 1.441 |
| 1-3/4   | DS-1228 | 3.228 | 2.126 | 2.480 | 1.005 | 1.480 |
| 1-13/16 | DS-1229 | 3.228 | 2.126 | 2.480 | 1.005 | 1.480 |
| 1-7/8   | DS-1230 | 3.228 | 2.126 | 2.559 | 1.063 | 1.559 |

## Deep Fractional

| SIZE    | PART #   | D1    | D2    | L     | T     | C     |
|---------|----------|-------|-------|-------|-------|-------|
| 1-1/4   | DS-1220L | 2.362 | 1.732 | 3.189 | 0.669 | 2.189 |
| 1-5/16  | DS-1221L | 2.480 | 1.732 | 3.189 | 0.748 | 2.189 |
| 1-3/8   | DS-1222L | 2.638 | 1.732 | 3.189 | 0.748 | 2.189 |
| 1-7/16  | DS-1223L | 2.638 | 1.732 | 3.189 | 0.748 | 2.189 |
| 1-1/2   | DS-1224L | 2.638 | 1.732 | 3.189 | 0.866 | 2.189 |
| 1-9/16  | DS-1225L | 3.071 | 2.126 | 3.189 | 0.866 | 2.189 |
| 1-5/8   | DS-1226L | 3.071 | 2.126 | 3.189 | 0.866 | 2.189 |
| 1-11/16 | DS-1227L | 3.228 | 2.126 | 3.189 | 0.984 | 2.189 |
| 1-3/4   | DS-1228L | 3.228 | 2.126 | 3.189 | 1.005 | 2.189 |
| 1-13/16 | DS-1229L | 3.228 | 2.126 | 3.189 | 1.005 | 2.189 |
| 1-7/8   | DS-1230L | 3.228 | 2.126 | 3.189 | 1.063 | 2.189 |

# Accessories

## Double Ended Female Adapters

| PART # | D1  | D2  | L     |
|--------|-----|-----|-------|
| AN1208 | 3/4 | 1/2 | 1.929 |
| AN1210 | 3/4 | 5/8 | 1.968 |
| AN1212 | 3/4 | 3/4 | 1.929 |
| AN1612 | 3/4 | 1   | 2.480 |



## Extensions

| PART # | L  |
|--------|----|
| E1203  | 3  |
| E1204  | 4  |
| E1205  | 5  |
| E1207  | 7  |
| E1213  | 13 |



## Adapters

| PART # | D1  | D2  | L     |
|--------|-----|-----|-------|
| A1208  | 3/4 | 1/2 | 2.165 |
| A1210  | 3/4 | 5/8 | 2.244 |
| A1216  | 3/4 | 1   | 2.322 |



## Double Ended Male Extensions

| PART # | D1 | L  |
|--------|----|----|
| Z1202  | 1  | 2  |
| Z1203  | 1  | 3  |
| Z1204  | 1  | 4  |
| Z1205  | 1  | 5  |
| Z1207  | 1  | 7  |
| Z1210  | 1  | 10 |
| Z1213  | 1  | 13 |
| Z1215  | 1  | 15 |
| Z1216  | 1  | 16 |



## Retaining Pins and Rings

| SQUARE DRIVE | THROUGH HEX SIZE | PIN # | RING # |
|--------------|------------------|-------|--------|
| 3/4          | 1-3/16 - 46mm    | P1244 | R1244  |
| 3/4          | Above 1-3/16     | P1254 | R1254  |

## Universal Joint

| SIZE | PART # |
|------|--------|
| 3/4  | U1212  |

