

PARTS LIST

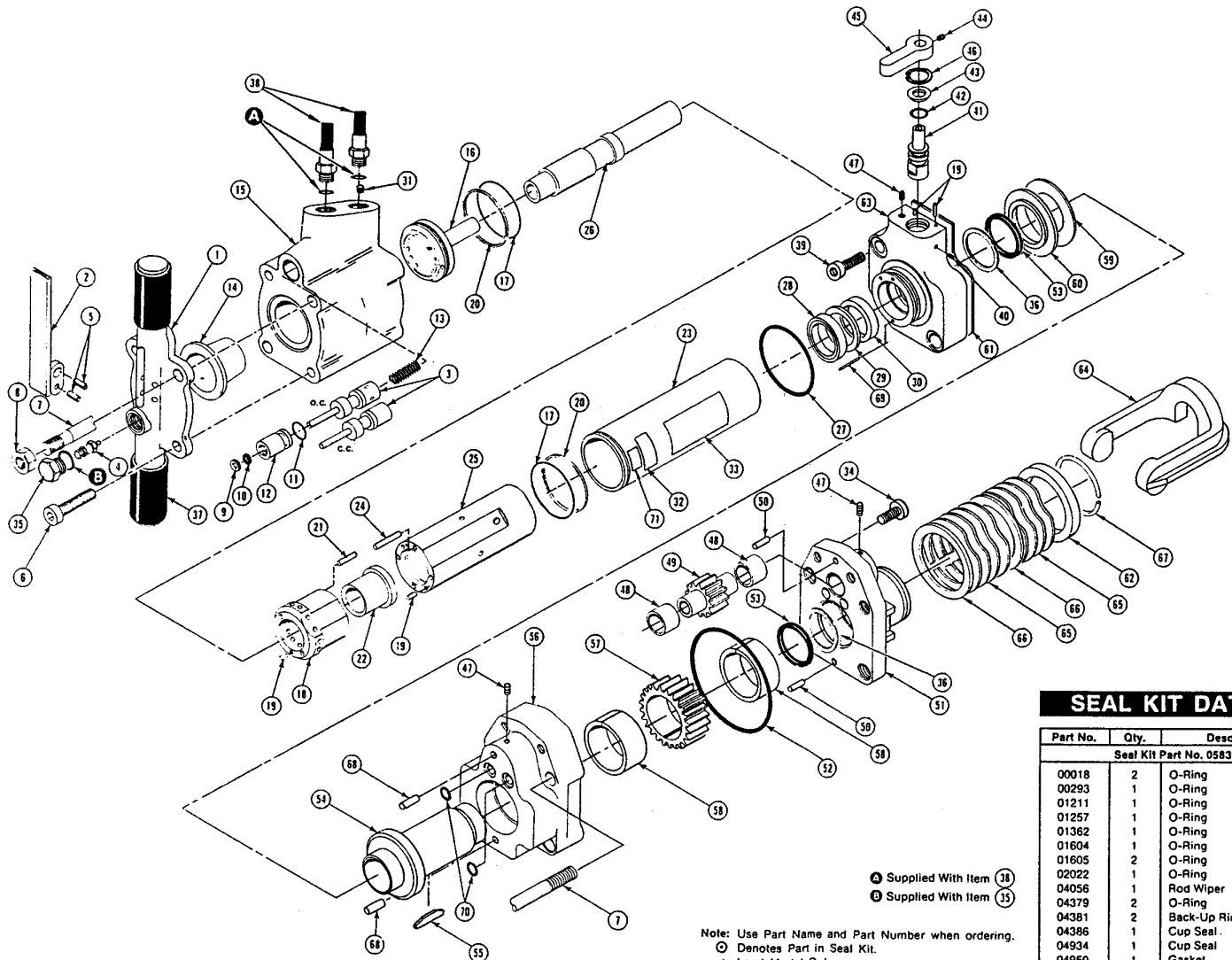

A Supplied With Item (18)
 B Supplied With Item (15)

Note: Use Part Name and Part Number when ordering.
 O Denotes Part in Seal Kit.
 * Land Model Only.
 ** Underwater Model Only.

SEAL KIT DATA

Part No.	Qty.	Description
Seal Kit Part No. 05839		
00018	2	O-Ring
00293	1	O-Ring
01211	1	O-Ring
01257	1	O-Ring
01362	1	O-Ring
01604	1	O-Ring
01605	2	O-Ring
02022	1	O-Ring
04056	1	Rod Wiper
04379	2	O-Ring
04381	2	Back-Up Ring
04386	1	Cup Seal
04934	1	Cup Seal
04950	1	Gasket
11196	2	Quad Ring
11197	2	Back-Up Ring

Item No.	Part No.	Qty.	Description
1	04369	1	Handle
2	04371	1	Trigger
3	04077	1	Valve Spool, o.c.
	04593	1	Valve Spool, c.c.
4	01650	1	Charging Valve
5	00844	2	Spirol Pin, 1/4 x 1/2
6	04372	2	Capscrew, 1/2-13 x 5 1/2 Hex Soc Hd
7	04932	2	Side Rod
8	04374	2	Locknut, 5/8-18
9	04056	1	Rod Wiper
10	01362	1	O-Ring, 5/16 x 7/16 x 1/16 O
11	00293	1	O-Ring, 11/16 x 7/8 x 3/32 O
12	04057	1	Bushing
13	04058	1	Spring
14	07479	1	Accumulator Diaphragm
15	05988	1	Accumulator - Valve Block Assy
16	04378	1	Porting Block
17	04379	2	O-Ring, 2 9/16 x 2 3/4 x 3/32 O
18	04380	1	Automatic Valve Body
19	02900	4	Roll Pin, 1/8 x 1/2
20	04381	2	Back-Up Ring, 2.581 x 2.753 x .053 O
21	04571	2	Push Pin, 3/16 x 1 1/4
22	04392	1	Automatic Valve
23	04333	1	Flow Sleeve Tube
24	04605	4	Push Pin, 1/4 x 1 1/2
25	04384	1	Flow Sleeve
26	04954	1	Piston
27	02022	1	O-Ring, 2 1/4 x 2 1/2 x 1/8 O
28	04386	1	Cup Seal
29	04780	1	Washer
30	04934	1	Cup Seal
31	05243	1	Orifice Plug
32	03786	1	GPM Sticker
33	05152	1	Stanley Sticker
34	00682	2	Capscrew, 3/8-16 x 1 3/4 Hex Soc Hd
35	07493	1	Charge Valve Cap
36	11197	2	Back-Up Ring
37	02494	2	Handle Grip
38	01652	2	Hose Assembly
39	04936	2	Capscrew, 1/2-13 x 4 1/2 Hex Soc Hd
40	00842	1	Set Screw, 10-24 x 5/16
41	04937	1	Motor Control Valve
42	01211	1	O-Ring, 5/8 x 3/4 x 1/16 O
43	04938	1	Washer
44	01607	1	Set Screw, 1/4-20 x 1/4
45	04939	1	Lever
46	04940	1	Retaining Ring, 13/16 Int.
47	00783	3	Pipe Plug, 1 1/8-27 NPT
48	03826	2	Bearing, 13 DU 12
49	04033	1	Idler Gear
50	00713	2	Dowel Pin, 1/4 x 1
51	04942	1	Motor Plate
52	01257	1	O-Ring, 3 1/2 x 3 5/8 x 1/16 O
53	11196	2	Quad Ring
54	04944	1	Drive Hex *
	06678	1	Drive Hex **
55	04787	1	Key
56	05976	1	Motor Chamber
57	05975	1	Drive Gear
58	04947	2	Bearing, 28 DU 16
59	04948	1	Thrust Washer
60	04949	1	Thrust Back-Up Washer
61	04950	1	Gasket
62	04759	1	Spring Back-Up
63	04951	1	Drive Motor Control Block *
	06600	1	Drive Motor Control Block **
64	04952	1	Latch
65	07063	8	Wave Spring
66	04756	2	Latch Washer
67	04761	1	Retaining Ring
68	01749	2	Roll Pin, 5/32 x 1/2
69	00114	1	Roll Pin, 5/32 x 1
70	00018	2	O-Ring, 7/16 x 9/16 x 1/16 O
71	03693	1	Closed Center Sticker (CC Model)